

PEPVZTM



GALVANISED STEEL THREADED STEM TYPE B - WITH MILLED SEAT FOR WRENCH - TURNED

Materials:

Free-cutting steel (39SMnPb36).

Surface finish:

Smooth.

Colour:

Blue galvanising.

Thread:

Turned stem with milled seat for wrench (type B) with rolled thread (thread tolerance 6g).

Special requests:

- Upon request and for special quantities the length and geometry of the inserts can be supplied to customer's drawing.

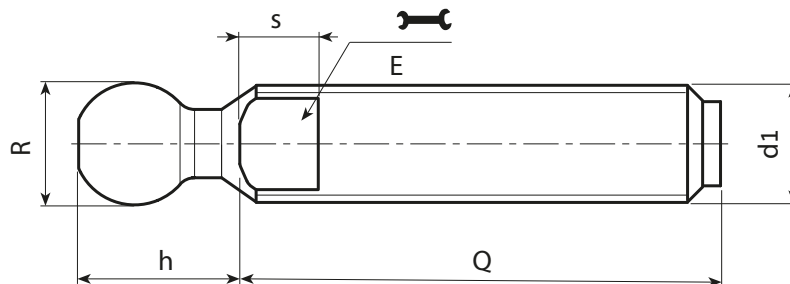

Version M16 with ball R. 12.4

Stock availability as % (🛒)
90% (🟢) - 40% (🟡) - 5% (🔴)

Art.	E	h	s	R ± 0.1	d1 $_{6g}$	Q	g
PEPVZTM16X..Z3	13	15	7	12.4	M16	70-90-110-130-150-170	98-124-150-176-202-228

These stems are compatible with the following foot bases: • PIE.040S12,4 • PIE.050S12,4 • PIE.060S12,4 • PIE.080S12,4 • PIE.700080S125

Enter the selected stud length in place of the two dots . . in the item code. Customised stud length available for a minimum of 100 pieces.

Version M20-M24 with ball R. 15

Art.	E	h	s	R	d1 $_{6g}$	Q	g
PEPVZTM20X..Z3	16	17	7	15	M20	50-70-90-110-130-150-170-190-210	142-174-206-238-270-305-337-370-405
PEPVZTM24X..Z3	19	17	8	15	M24	150-170-190-210	510-570-630-690

These stems are compatible with the following foot bases: • PIE.060S15 • PIE.080S15 • PIE.105S15 • PIE.130S15 • PIE.700080S15

Enter the selected stud length in place of the two dots . . in the item code. Customised stud length available for a minimum of 100 pieces.

Version M24-M30 with ball R. 24

Art.	E	h	s	R	d1 $_{6g}$	Q	g
PEPVZTM24X..Z5	19	27	10	24	M24	110-130-150-170	390-450-510-570
PEPVZTM30X..Z5	27	27	11	24	M30	110-130-150-170-190-210	550-637-725-813-900-990

These stems are compatible with the following foot bases: • PIE.080S24 • PIE.105S24 • PIE.130S24 • PIE.700080S24

Enter the selected stud length in place of the two dots . . in the item code. Customised stud length available for a minimum of 100 pieces.



Arbel Agencies LTD.

11 Ba'alei Hamelacha st. Qiryat Bialik P.O.B 1095, ZIP 2751311, ISRAEL
+972(0)48736969 ☎ +972(0)48730708 📠 info@arbel-ltd.com 📧 www.arbel-ltd.com 🌐

