

# B240

## SOLID HANDLE WITH SCREW AND NUT



### Materials:

Reinforced polyamide.  
Resistant to oils and greases.

### Surface finish:

Satin.

### Colour:

Black: (RAL 9011 code 01).

### Inserts:

#### B240:

2 galvanised steel screws DIN 912.  
2 galvanised steel nuts DIN 934.  
2 galvanised steel perforated washers.

#### B240CIN:

2 stainless steel screws (Aisi 304) DIN 912.  
2 stainless steel nuts (Aisi 304) DIN 934.  
2 stainless steel perforated washers (Aisi 304).

### Special requests:

- None.

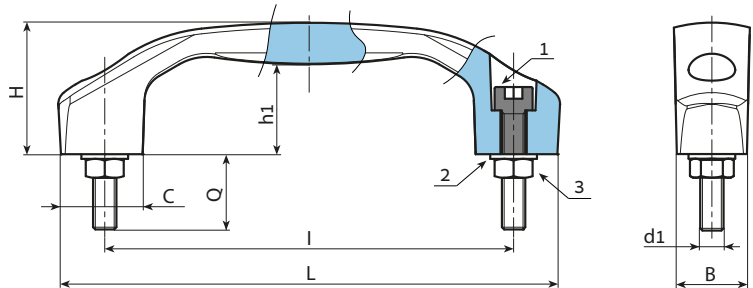

### Version B240: with galvanised steel inserts

Stock availability as % (🛒)  
90% (●) - 40% (●) - 5% (●)

🛒	art.	L	I	B	C	H	h1	d1 <sub>6g</sub>	Q	g	F1 (N)
●	B240100.TM05X2001	122	100	17	20	33	23,5	M5	20	53	1000
●	B240120.TM06X2501	146	120	21	24	39	27,5	M6	25	93	1000
●	B240140.TM08X3001	170	140	24	28	45	31	M8	30	150	1000

### Version B240CIN: with stainless steel inserts (Aisi 304)



🛒	art.	L	I	B	C	H	h1	d1 <sub>6g</sub>	Q	g	F1 (N)
●	B240100.TM05X2001CIN	122	100	17	20	33	23,5	M5	20	53	1000
●	B240120.TM06X2501CIN	146	120	21	24	39	27,5	M6	25	93	1000
●	B240140.TM08X3001CIN	170	140	24	28	45	31	M8	30	150	1000

### Arbel Agencies LTD.



11 Ba'alei Hamelacha st. Qiryat Bialik P.O.B 1095, ZIP 2751311, ISRAEL  
+972(0)48736969 ☎ +972(0)48730708 📠 info@arbel-ltd.com 🌐 www.arbel-ltd.com 🌐

