

# AP1016

## VACUUMPUMP

### SPECIFICATIONS

Rated Vacuum:	-35 kPa (-350 mB, -10.34 inHg)
Rated Voltage (s):	100V, 120V, or 230V
Maximum Vacuum Airflow:	>3.0 l/min (0.106 cfm)
Maximum Vacuum:	>-67kPa (-670mB, -19.78 inHg)
Rated Frequency:	50Hz or 60Hz
Power Consumption:	14-15 Watts
Duty Cycle:	Continuous
Coil insulation Class:	Class F. Class B for UL (1450) (120V)
Noise Level:	Below 40 dB (A)
Environmental Conditions:	0°C - 40°C & 35% - 85% RH
Mounting Dimensions:	48(L) x 62(W) mm
Unit outside dimensions:	99mm x 58mm x 58mm
Gross Weight:	700grams (1.54lbs)
Lead Wire Length:*	AWG22 (UL1015, 105°C) X 260mm
Outlet:*	7.5mm diameter bard, hose nipple.

\*Example given. Customer determined attributes are available.  
Patented and patents pending

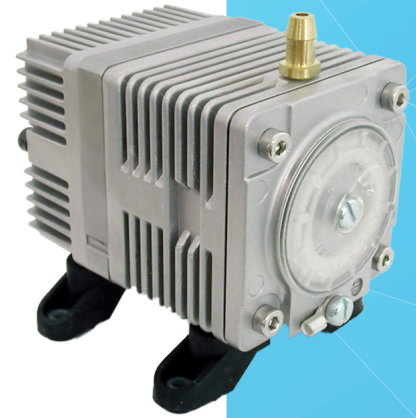

Images are for reference only

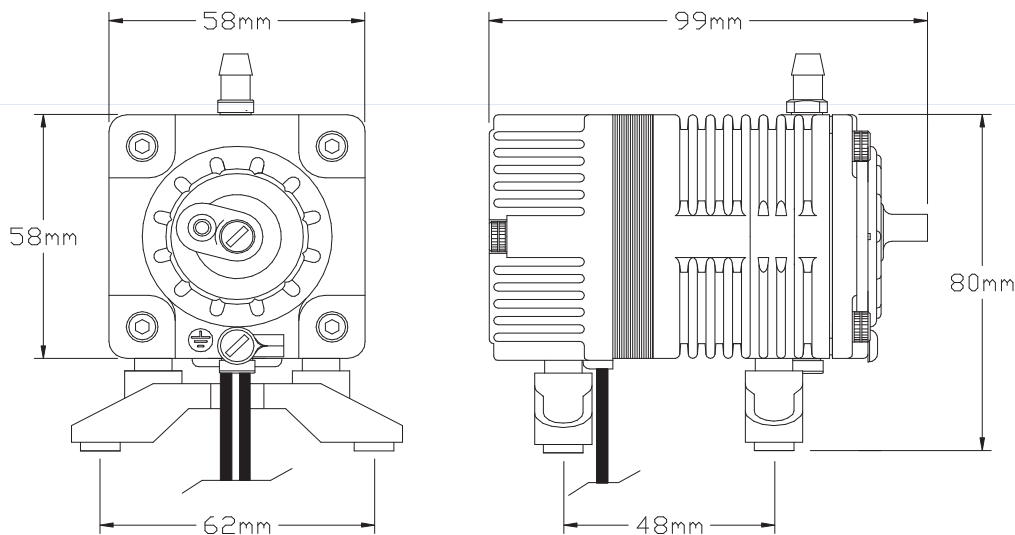
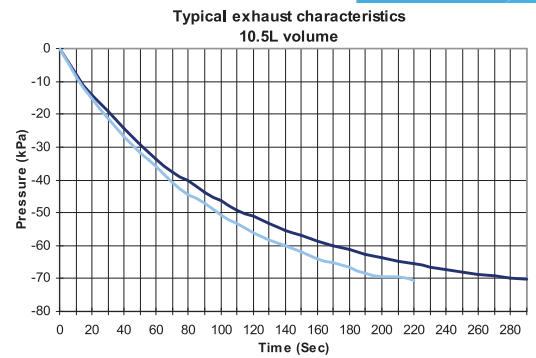

Contact technical sales for additional information regarding life expectancy and operating conditions.  
All the information in this datasheet is supplied in good Faith.  
This information is given without obligation or liability.