

A592CIN



INOX

INDEXED ZAMAK CLAMPING LEVER WITH THREADED STAINLESS STEEL INSERT

Materials:

Lever body in die-cast zamak (zinc, aluminium and copper alloy).

Surface finish:

Smooth. Epoxy powder coating.

Lever body colour:

Glossy black (RAL 9005 cod. 01).
 Matt black (RAL 9005 cod. 20).
 Orange (RAL 2004 code 02).
 Red (RAL 3000 code 16).
 Silver (RAL 9006 cod. 83).
 Grey (RAL 7031 cod. 80).
 Blue (RAL 5015 code 07).
 Untreated lever (code GRE).

Inserts:

Stainless steel insert with female threaded hole (Aisi 303) (thread tolerance 6H).

Fixing screw:

Stainless steel screw (AISI 303) with hexagon socket head.

Spring:

Stainless steel spring (Aisi 302).

Special requests:

- None.

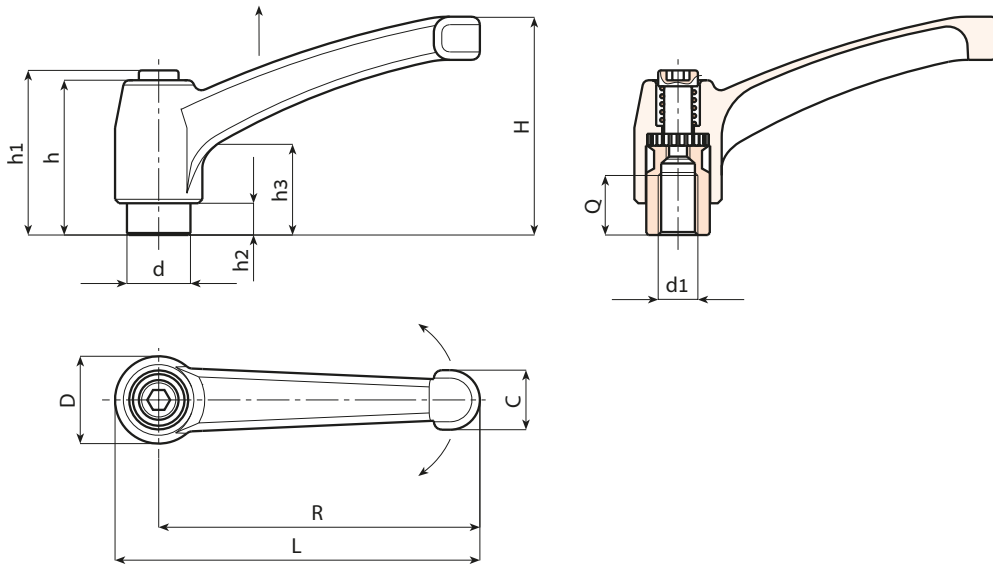

INOX

Stock availability as % (🛒)
 90% (●) - 40% (●) - 5% (●)

🛒	Art.	L	R	H	D	d	c	h	h1	h2	h3	d16H	Q	📦
●	A592043.ZM05..CIN	50	43	30	14	10	9	26	30	5	14	M5	9	30
●	A592043.ZM06..CIN	50	43	30	14	10	9	26	30	5	14	M6	9	28
●	A592065.ZM06..CIN	75	65	45	19	14	13	32	34	7	14	M6	10	78
●	A592065.ZM08..CIN	75	65	45	19	14	13	32	34	7	14	M8	10	76
●	A592065.ZM10..CIN	75	65	45	19	14	13	32	34	7	14	M10	10	74
●	A592080.ZM08..CIN	91	80	57	22	16	16	40	42	8	16	M8	14	134
●	A592080.ZM10..CIN	91	80	57	22	16	16	40	42	8	16	M10	13	130
●	A592080.ZM12..CIN	91	80	57	22	16	16	40	42	8	16	M12	12	128
●	A592094.ZM10..CIN	107	94	65	26	20	18	47	50	10.5	19	M10	17	191
●	A592094.ZM12..CIN	107	94	65	26	20	18	47	50	10.5	19	M12	17	195
●	A592094.ZM14..CIN	107	94	65	26	20	18	47	50	10.5	19	M14	17	190
●	A592108.ZM14..CIN	123	108	75	30	23	20	54	56	12	23	M14	26	298
●	A592108.ZM16..CIN	123	108	75	30	23	20	54	56	12	23	M16	26	284

In place of the two dots . . enter the selected colour code. Example: Lever R80 M10 Red - A592080.ZM1016CIN

Arbel Agencies LTD.



11 Ba'alei Hamelacha st. Qiryat Bialik P.O.B 1095, ZIP 2751311, ISRAEL
 +972(0)48736969 ☎ +972(0)48730708 📠 info@arbel-ltd.com 📧 www.arbel-ltd.com 🌐

