

M720 UPDATE



RECTANGULAR HANDLE WITH SELF-FIX HOLE

Material:

Blend of polypropylene and thermoplastic rubber TPV.

Surface:

Glossy.

Colour:

Black (RAL 9011).

Hole:

Female smooth hole, obtained by moulding the plastic.

Fixing:

Push fit.

SPECIAL REQUEST:

- None.

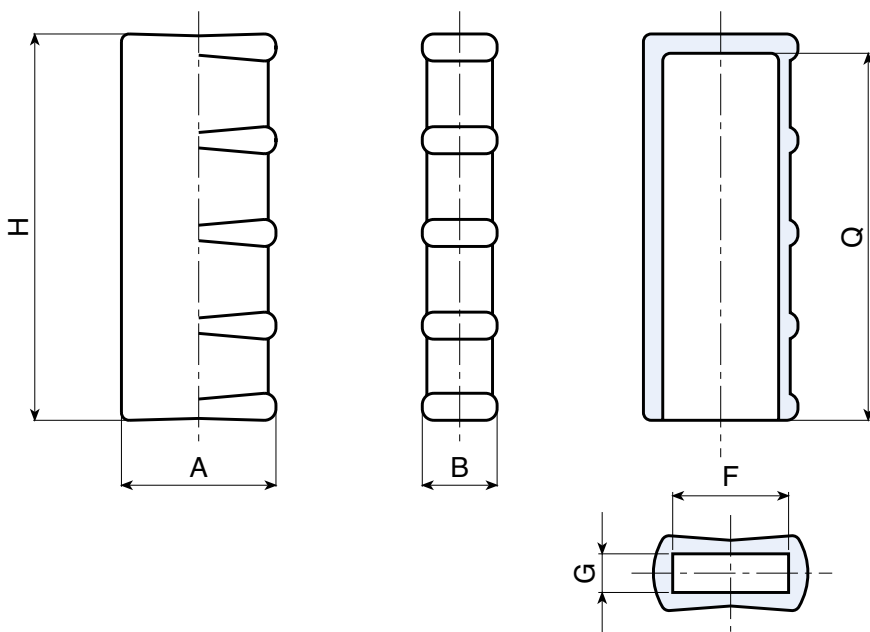

| | art. | H | A | B | G ± 0,2 | F ± 0,2 | Q | Δ g |
|---|---------------------|-----|----|----|---------|---------|----|-----|
| ● | M720079.TG05X2001 | 79 | 32 | 17 | 5 | 20 | 76 | 29 |
| ● | M720079.TG06X2001 | 79 | 32 | 17 | 6 | 20 | 76 | 27 |
| ● | M720079.TG08X2001 | 79 | 32 | 17 | 8 | 20 | 76 | 24 |
| ★ | ● M720079.TG08X2501 | 79 | 32 | 17 | 8 | 25 | 76 | 23 |
| ★ | ● M720079.TG10X2001 | 77 | 32 | 17 | 10 | 20 | 76 | 22 |
| ★ | ● M720100.TG05X2001 | 101 | 40 | 20 | 05 | 20 | 96 | 51 |
| ★ | ● M720100.TG06X3001 | 101 | 40 | 20 | 06 | 30 | 96 | 48 |
| ★ | ● M720100.TG08X2501 | 101 | 40 | 20 | 08 | 25 | 96 | 46 |
| ● | M720100.TG10X2801 | 101 | 40 | 20 | 10 | 28 | 96 | 43 |
| ● | M720100.TG10X3001 | 101 | 40 | 20 | 10 | 30 | 96 | 42 |

Presumable presence in the stock in %

90% ● 40% ● 5% ●