

K901



SOLID CONTROL HANDWHEEL WITH INDICATOR SEAT AND WITH LOCKIN KNOB

Material:

Reinforced polyamide.
Oils and greases resistant.

Surface: Satin.

Colour: Black (RAL 9011).

Main Insert:

Zinc plated steel right through bored bush with H10 tolerance.

Indicator mountable:

Use gravitational indicators K650 or K660 series. The indicator can be used in a vertical position (horizontal axis machine). The indicator and the grub screw (d7) must be purchased separately. For further information on the indicators refer to page K-24/25.

(*) With the adapter KS08050.T01 you can mount the indicator K650080.

Locking knob:

Cylindrical knob black (Ral 9011) art. G793-36 with threaded stud (page G-12).

Caution: the Q2 dimension of the knob must be chosen by the customer according to the dimensions of the machinery on which it will be installed. For Model K901-130 the knob is replaced with the wingnut L751-32 (page L-19).

For fixing system, or execution of keyway or square holes, please refer to the technical notes attached to the catalogue.

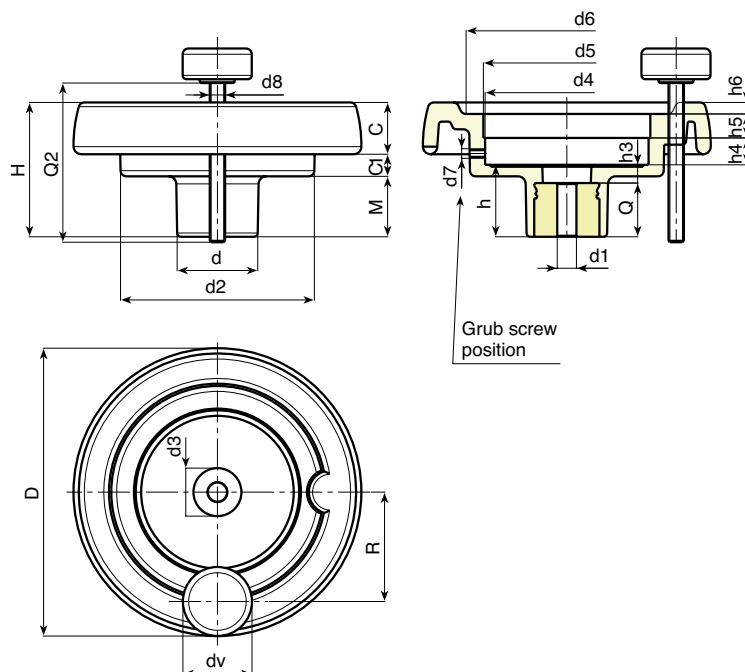

SPECIAL REQUESTS:

- It is possible to supply the inserts with d1 diameter by customers design, on request and for quantities.
- It is possible to supply the inserts in different materials, on request and for quantities.
- It is possible to supply the handwheels complete with indicators.
- Upon request and for quantities the indicator seat can be adjusted.

Matches diameters / Indicators:

d5=52,4 --> K650050
d5=87,4 --> K650080 o K660080
d5=124,4 --> K650120

Version with zinc plated insert and H10 tolerance bore

art.	D	H	d	d2	M	C	C1	d3	d4	d5 (K650)	d6	d7	h	h3	h4	h5	h6	R	d8	Dm	d1 H10	Q	Δg
K901130.T080D6,801P	129	64,5	42	100	27,5	23	14	29	85,7	87,4*	90	M6	34	10	13,5	12,5	5	54	M8	20	6,8	24	370
K901150.T080D6,801P	149	69	42	101	31	25,5	12,5	29	85,7	87,4*	106	M6	37	9	13,5	12,5	6,5	57	M8	20	6,8	28	470
K901175.T080D6,801P	175	72	40	115	28,5	32	11,5	25	85,7	87,4*	126,5	M6	38	10	12,5	14	8	60	M8	20	6,8	28	690
K901200.T120D6,801P	199	71	46	137	24	32	15	29	123	124,4	144	M6	34	11	13,5	12,5	10	74	M8	22	6,8	23	850

Attention: bore d1 (H10 tolerance) could be produced by request, with 50 pieces minimum.

Dm = It's possible to increase the hole, by boring, until Dm (enlarge). **Q2** = by request. **dv** = 36 mm. (K901130 dv= 32 mm.)

Version with black-oxide insert and H7 tolerance bore

art.	D	H	d	d2	M	C	C1	d3	d4	d5 (K650)	d6	d7	h	h3	h4	h5	h6	R	d8	Dm	d1 H7	Q	Δg
K901130.T080D..01PZB	129	64,5	42	100	27,5	23	14	29	85,7	87,4*	90	M6	34	10	13,5	12,5	5	54	M8	20	A.R.	24	370
K901150.T080D..01PZB	149	69	42	101	31	25,5	12,5	29	85,7	87,4*	106	M6	37	9	13,5	12,5	6,5	57	M8	20	A.R.	28	470
K901175.T080D..01PZB	175	72	40	115	28,5	32	11,5	25	85,7	87,4*	126,5	M6	38	10	12,5	14	8	60	M8	20	A.R.	28	690
K901200.T120D..01PZB	199	71	46	137	24	32	15	29	123	124,4	144	M6	34	11	13,5	12,5	10	74	M8	22	A.R.	23	850

Attention: replace the two places in the code .. with the hole diameter required - 50 pieces minimum.

dv = 36 mm. (K901130 dv= 32 mm.)

Dm = It's possible to increase the hole, by boring, until Dm (enlarge).

A.R. = by request

Q2 = by request.